

00 = Engine

Table 3

Carburetor

00 = Engine / Carburetor

R 50 • R 50 S • R 60 • R 69 S

Table 3

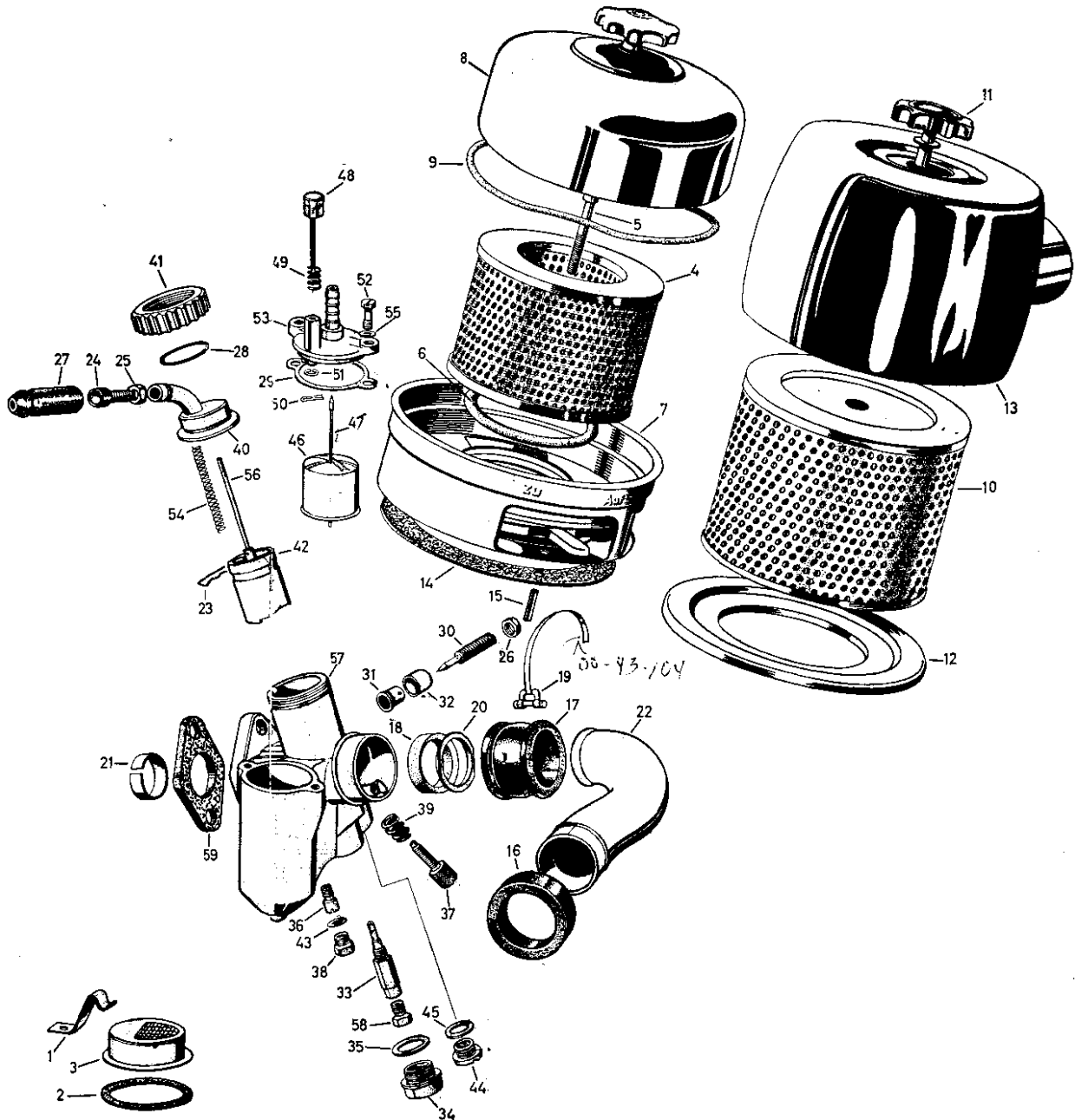

Ordering No.	Call-out No.	Description of Part	Qty.				
			R 50 60	R 50/2 60/2	R 50 S	R 69	R 69 S
Air Filter in Engine Housing							
00 43 136	1	Retaining spring	1	1	1	1	1
99 63 493	2	Gasket (sealing) A 48×55 rubber	1	1	1	1	1
00 43 140	3	Wet air filter cartridge	1	1	1	1	1
99 13 425	—	Hex.-head screw M 6×10—8 G pho.black ..	1	1	1	1	1
Air filter on Transmission Housing, Top							
00 43 033	—	Air Filter, complete	1	1	—	1	—
00 43 524	4	Micronic Filter	1	1	—	1	—
00 43 157	5	Fastening screw with spring washer for filter	—	1	—	—	—
00 43 156	6	Housing gasket	1	2	—	1	—
00 43 170	7	Filter base, complete	—	1	—	—	—
00 43 171	8	Filter cover, complete	—	1	—	—	—
00 43 152	9	Cover gasket	1	—	—	1	—
00 43 035	—	Air filter with fine mesh cartridge, complete	—	R 50/2 1	—	—	1
00 43 145	10	Fine mesh filter cartridge	—	R 50/2 1	—	—	1
00 43 158	11	Filter retaining screw	—	—	1	—	1
00 43 154	—	Housing gasket, top for filter cartridge	—	—	1	—	1
00 43 172	12	Filter base	—	—	1	—	1
00 43 173	13	Filter top	—	—	1	—	1
00 43 119	14	Gasket for air filter	1	1	1	1	1
99 41 365	15	Locking sleeve 4×16 in transmission housing for Micronic filter	—	1	—	—	—
Air Intake Pipes							
00 43 163	16	Gasket on transmission housing side	4	2	2	—	—
00 43 165	16	Seal ring on transmission housing side	—	—	—	2	2
00 43 161	17	Sleeve for air intake pipes on carburetor side	2	2	2	—	—
00 43 162	18	Seal ring for air intake pipes on carburetor side	—	—	—	2	2
00 43 104	19	Hose clamp for sleeve on carburetor side ..	4	—	—	—	—
99 48 811	19	Fastening clip S 42:9 cad. for sleeve on carburetor side	—	4	4	—	—

Ordering No.	Call-out No.	Description of Part	Qty.				
			R 50 60	R 50/2 60/2	R 50 S	R 69	R 69 S
00 43 166	20	Limit ring for seal ring on carburetor side ..	—	—	—	2	2
00 43 168	21	Centering bushing for seal ring on carburetor side	—	—	—	2	2
00 43 174	22	Air intake pipe, left, for R 50, R 50/2	R 50 1	R 50/2 1	—	—	—
00 43 175	22	Air intake pipe, right, for R 50, R 50/2	R 50 1	R 50/2 1	—	—	—
00 43 182	22	Air intake pipe, left, for R 60, R 60/2	R 60 1	R 60/2 1	—	—	—
00 43 183	22	Air intake pipe, right, for R 60, R 60/2	R 60 1	R 60/2 1	—	—	—
00 43 176	22	Air intake pipe, left	—	—	1	—	—
00 43 177	22	Air intake pipe, right	—	—	1	—	—
00 43 178	22	Air intake pipe, left	—	—	—	1	1
00 43 179	22	Air intake pipe, right	—	—	—	1	1
Carburetor							
00 39 038	—	Flange carburetor, right, for R 50, R 50/2	R 50 1	R 50/2 1	—	—	—
00 39 039	—	Flange carburetor, left, for R 50, R 50/2	R 50 1	R 50/2 1	—	—	—
00 39 042	—	Flange carburetor, right, for R 60	R 60 1	—	—	—	—
00 39 044	—	Flange carburetor, left, for R 60	R 60 1	—	—	—	—
00 39 032	—	Flange carburetor, right, for R 60/2	—	R 60/2 1	—	—	—
00 39 033	—	Flange carburetor, left, for R 60/2	—	R 60/2 1	—	—	—
00 39 040	—	Flange carburetor, right	—	—	1	—	—
00 39 041	—	Flange carburetor, left	—	—	1	—	—
00 39 034	—	Flange carburetor, right	—	—	—	1	—
00 39 035	—	Flange carburetor, left	—	—	—	1	—
00 39 036	—	Flange carburetor, right	—	—	—	—	1
00 39 037	—	Flange carburetor, left	—	—	—	—	1
00 39 176	23	Retaining clip	2	2	—	—	—
00 39 175	23	Retaining clip	—	—	2	2	2
00 39 178	24	Throttle cable adjuster	2	2	2	2	2
00 39 182	25	Nut for cable adjuster	2	2	2	2	2
00 39 184	26	Nut for pilot air screw	2	2	2	2	2
00 42 111	27	Rubber cover for throttle cable	2	2	2	2	2
00 42 149	28	Rubber seal ring for cover plate	2	2	2	2	2
00 42 150	29	Gasket for float bowl	2	2	2	2	2
00 39 181	30	Air pilot screw	2	2	2	2	2
00 39 183	31	Bushing for overflow drain-out	2	2	2	2	2

Ordering No.	Call-out No.	Description of Part	Qty.				
			R 50 60	R 50/2 60/2	R 50 S	R 69	R 69 S
00 39 185	32	Cap for overflow drain-out	2	2	2	2	2
00 39 124	33	Needle jet (1308)	2	2	—	—	—
00 39 123	33	Needle jet (1208)	—	—	2	2	2
00 39 129	33	Needle jet (2108)	—	—	—	—	2
00 39 199	34	Plug	2	2	—	—	—
00 39 197	34	Plug	—	—	2	2	2
00 42 130	35	Gasket	2	2	2	2	2
00 39 135	36	Idling jet No. 35	2	—	—	2	—
00 39 137	36	Idling jet	—	2	2	—	2
00 39 527	37	Float limit screw	2	2	2	2	2
00 39 196	38	Screw	2	2	4	4	4
00 39 171	39	Spring	2	2	—	—	—
00 39 170	39	Spring	—	—	2	2	2
00 39 111	40	Cover plate, left	1	1	—	—	—
00 39 112	40	Cover plate, right	1	1	—	—	—
00 39 218	40	Cover plate, left	—	—	1	1	1
00 39 219	40	Cover plate, right	—	—	1	1	1
00 39 217	41	Retainer	2	2	—	—	—
00 39 216	41	Retainer	—	—	2	2	2
00 39 120	42	Throttle slide	2	2	—	—	—
00 39 117	42	Throttle slide	—	—	2	2	2
00 42 126	43	Gasket	2	2	4	2	4
00 39 198	44	Plug	2	2	2	2	2
00 42 134	45	Gasket	2	2	2	2	2
00 39 187	46	Float 7 grams	2	2	2	2	2
00 39 288	47	Float needle	2	2	2	2	2
00 39 260	48	Tickler	2	2	2	2	2
00 39 164	49	Tickler spring	2	2	2	2	2
00 39 165	50	Cotter pin	2	—	—	2	—
00 39 262	51	Lock washer for tickler	—	2	2	—	2
00 39 156	52	Fastening screw	4	4	—	—	—
00 39 159	52	Fastening screw	—	—	4	4	4
00 39 259	53	Float bowl cover <i>12-52-176</i>	2	2	2	2	2
00 39 169	54	Throttle spring	2	2	—	—	—
00 39 168	54	Throttle spring	—	—	2	2	2
00 39 193	55	Spring washer for fastening screw	—	4	4	—	4

Ordering No.	Call-out No.	Description of Part	Qty.				
			R 50 60	R 50/2 60/2	R 50 S	R 69	R 69 S
00 39 274	56	Jet needle	2	2	—	—	—
00 39 272	56	Jet needle	—	—	2	2	2
00 39 207	57	Carburetor body, left	1	1	—	—	—
00 39 208	57	Carburetor body, right	1	1	—	—	—
00 39 213	57	Carburetor body, left	—	—	1	1	1
00 39 212	57	Carburetor body, right	—	—	1	1	1
00 39 244	58	Main jet No. 105	2	R 50/2 1	—	—	—
00 39 144	58	Main jet No. 110	—	R 60/2 1	—	—	—
00 39 239	58	Main jet No. 135	—	—	2	—	2
00 39 245	58	Main jet No. 115	—	—	—	2	—
For carburetors to cylinderheads							
00 42 146	59	Gasket for carburetor, left and right	2	2	—	—	—
00 42 147	59	Gasket for carburetor, left and right	—	—	2	2	2