

30 = {
Rear Wheel Drive
Rear Wheel Brake

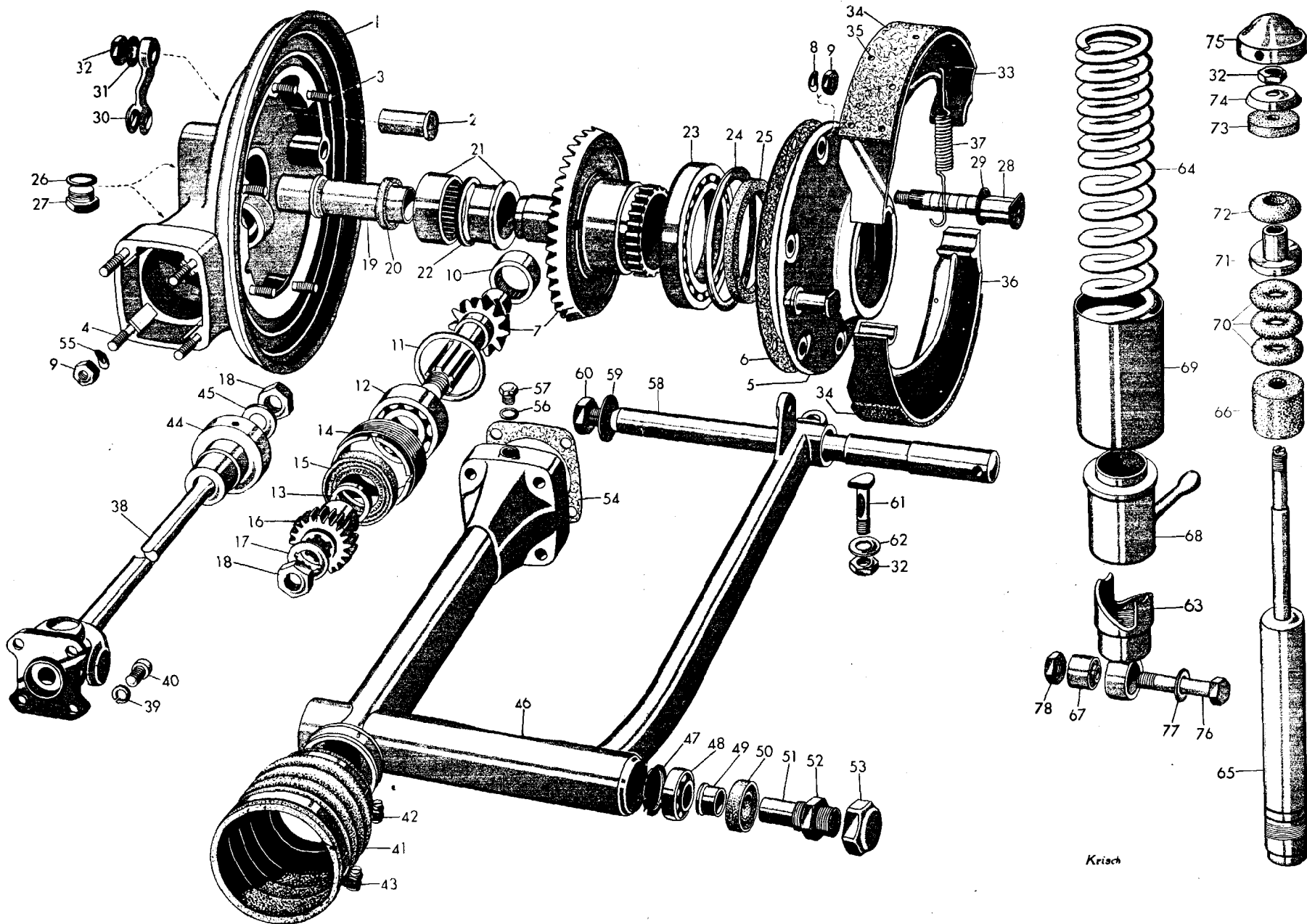

Ordering No.	Call-out No.	Description of Part	Qty.
		Rear wheel drive with swingarm	
30 04 030	—	rear wheel drive, 35:11 ratio for solo motorcycle ... R 50 up to vehicle No. 555 005 R 69 up to vehicle No. 652 304	1
30 04 031	—	R 50 from vehicle No. 555 006 R 69 from vehicle No. 652 305	
30 04 035	—	rear wheel drive, 32:11 ratio for solo motorcycle, R 60	1
30 04 032	—	rear wheel drive, 34:8 for sidecar motorcycle	1
		R 50 up to vehicle No. 555 005 R 69 up to vehicle No. 652 304	
30 04 033	—	R 50 from vehicle No. 555 006 R 69 from vehicle No. 652 305	
30 04 034	—	rear wheel drive, 26:6 ratio for sidecar motorcycle . R 50 from vehicle No. 555 006 R 69 from vehicle No. 652 305	1
30 04 029	—	rear wheel drive, 27:7 ratio for sidecar motorcycle R 60	1
30 04 304	1	bevel gear housing with studs	1
		R 50 up to vehicle No. 555 005 R 69 up to vehicle No. 652 304	
30 04 317	2	bushing	1
99 03 503	3	stud M 8×1×15 Sn—5 S pho.black. (E)	6
99 03 530	4	stud M 8×1×28 Sn—pho.black. (E)	4
30 04 309	5	cover with bearing for bevel gear housing	1
		R 50 up to vehicle No. 555 005 R 69 up to vehicle No. 652 304	
30 04 310	5	R 50 from vehicle No. 555 006 R 69 from vehicle No. 652 305 R 60	
30 04 319	6	gasket between bevel gear housing and cover R 50 up to vehicle No. 555 005 R 69 up to vehicle No. 652 304	1

Ordering No.	Call-out No.	Description of Part	Qty.
30 04 320	6	R 50 from vehicle No. 555 006 R 69 from vehicle No. 652 305 R 60	
30 10 170	—	bevel gear with pinion, set, 35:11 ratio, for solo motorcycle	1
		R 50 up to vehicle No. 555 005 R 69 up to vehicle No. 652 304	
30 10 171	7	R 50 from vehicle No. 555 006 R 69 from vehicle No. 652 305	
30 10 183	7	bevel gear with pinion, 32:11 ratio, for solo motorcycle, R 60	1
30 38 240	—	inner ring for pinion for solo motorcycle	1
		R 50 up to vehicle No. 555 005 R 69 up to vehicle No. 652 304	
30 10 174	—	bevel gear with pinion, 34:8 ratio, for sidecar motorcycle	1
		R 50 up to vehicle No. 555 005 R 69 up to vehicle No. 652 304	
30 10 175	—	R 50 from vehicle No. 555 006 R 69 from vehicle No. 652 305	
30 10 181	—	bevel gear with pinion, 26:6 ratio, for sidecar motorcycle	1
		R 50 from vehicle No. 555 006 R 69 from vehicle No. 652 305	
30 10 185	—	bevel gear with pinion, 27:7 ratio, for sidecar motorcycle, R 60	1
		inner ring for pinion needle bearing	1
		R 50 up to vehicle No. 555 005 R 69 up to vehicle No. 652 304	
99 32 091	8	spring washer B 8	6
99 21 606	9	nut M 8×1—6 S pho.black.	6
		Pinion bearing in bevel gear housing	
30 38 244	—	bearing needle, R 50 up to vehicle No. 555 005, R 69 up to vehicle No. 652 304	28

Ordering No.	Call-out No.	Description of Part	Qty.
30 38 245	10	JNA-needle bearing, R 50 from vehicle No. 555 006, R 69 from vehicle No. 652 305	1
30 38 198	11	spacer	1
99 82 467	12	tapered bearing 3304 X	1
30 38 248	13	spacer	1
30 38 252	14	threaded ring	1
30 38 256	15	seal	1
30 38 260	16	clutch spline	1
30 38 264	17	lock plate	1
99 21 630	18	nut M 14×1,5—6 S pho.black.	1
Bevel gear bearing support in bevel gear housing			
30 04 334	19	bushing	1
30 04 336	20	seal	1
30 04 338	21	JNA-needle bearing	1
30 04 340	22	spacer	1
99 81 760	23	roller bearing 16013	1
30 04 344	24	shim (thickness as required)	1
30 04 342	25	seal	1
Oil inlet and oil drain in bevel gear housing			
99 63 242	26	gasket C 14×20 steel-asbestos	2
99 63 259	26	gasket C 16×20 steel-asbestos (for part No. 00 07 108) (for R 69, only 1 req.)	as req.
00 07 104	27	plug (for R 69, only 1 req. for oil inlet)	2
00 07 106	27	plug, 0,1 mm, oversize, (for R 69 only 1 req.)	as req.
00 07 108	27	plug, with thread M 16×1,5 (as a replacement for part No. 00 07 106, when the thread is damaged) (for R 69, only 1 req. for oil inlet)	as req.
00 07 161	—	drain plug with magnet for oil drain (only for R 69)	1
00 07 160	—	drain plug with magnet for oil drain, 0,1 mm, oversize (for R 69)	1
00 07 162	—	drain plug with magnet for oil drain, with thread M 16×1,5 (when the thread is damaged) only for R 69)	1

Ordering No.	Call-out No.	Description of Part	Qty.
Rear wheel brake			
30 60 216	28	eccentric	1
30 60 107	29	plate for eccentric	1
30 60 206	30	brake lever for solo motorcycle	1
30 60 207	—	brake lever with threaded hole for sidecar motorcycle	1
30 60 206	—	brake lever for sidecar motorcycle	1
99 36 225	31	star washer J 10,5 pho.	1
99 21 617	32	nut M 10×1—6 S pho.black.	1
30 60 244	33	upper brake shoe with lining, rear	1
30 60 230	34	brake lining for upper and lower brake shoe	2
20 00 196	35	copper rivet	18
30 60 248	36	lower brake shoe with lining, rear	1
20 60 237	37	spring	2
Drive shaft with universal joint			
30 38 032	38	drive shaft with universal joint	1
30 38 220	39	lock washer	4
99 19 725	40	screw M 8×1×15—8 G pho.black.	4
30 38 224	41	rubber sleeve to cover universal joint	1
30 38 228	42	clamp for rubber sleeve, rear	1
30 38 232	43	clamp for rubber sleeve, front	1
30 38 237	44	coupling ring	1
99 31 681	45	washer 15 St. pho.black.	1
09 21 630	18	nut M 14×1,5—6 S pho.black.	1
Rear swingarm with bearing support			
30 54 260	46	swingarm with bearing support	1
30 54 168	47	cover plate	1
99 85 005	48	roller bearing 30 203	2
20 00 324	49	bushing	2
20 00 330	50	seal	2
30 54 170	51	bearing retainer	2

Ordering No.	Call-out No.	Description of Part	Qty.
30 54 174	52	nut	2
30 54 172	53	cap nut	2
30 54 266	54	gasket	1
99 32 080	55	spring washer A 8	4
99 22 094	9	nut M 8×1—6 S pho.black.	4
99 63 086	56	gasket C 10×14 steel-asbestos	2
99 19 215	57	plug AM 10×1—6 S pho.black.	2
Rear wheel axle			
30 04 368	58	axle	1
30 04 378	59	spacer	1
99 22 155	60	nut M 14×1,5—6 S	1
30 54 176	61	bolt	1
99 31 076	62	washer 10,5 St. pho.black.	1
99 21 617	32	nut M 10×1—6 S pho.black.	1
Shock absorber/spring assembly, rear			
30 54 034	—	shock absorber/spring assembly, left	1
30 54 035	—	shock absorber/spring assembly, right	1
30 54 038	—	shock absorber/spring assembly, for sidecar motorcycle, left	1
30 54 039	—	shock absorber/spring assembly, for sidecar motorcycle, right	1
30 54 280	63	shock absorber/spring assembly cup, left	1
30 54 281	—	shock absorber/spring assembly cup, right	1
30 54 284	64	spring 7 cm dia. for solo motorcycle	2
30 54 286	—	spring 7,6 cm dia. for sidecar motorcycle	2
30 54 290	65	shock absorber, with nut	2
20 54 236	66	shock absorber seal	2
30 54 296	67	silent bloc	2
30 54 194	68	adjustment, with cam rider	2
30 54 240	69	cover, bottom	2
30 54 528	70	bottoming ring	2

Ordering No.	Call-out No.	Description of Part	Qty.
30 54 200	71	top plate	2
30 54 204	72	rubber bumper	2
30 54 208	73	rubber bumper	2
30 54 210	74	cup	2
30 54 212	75	cover	2
Shock absorber/spring assembly, on left swingarm			
99 14 625	76	nut M 12×1,5×45—8 G cad.	1
99 31 084	77	washer 13—St. cad.	1
99 21 626	78	nut M 12×1,5—6 S cad.	1
Shock absorber/spring assembly, on bevel gear housing			
30 54 270	—	screw	1
99 31 084	—	washer 13—St. cad.	1
30 54 274	—	spacer	1